

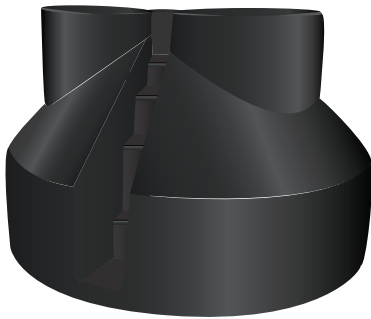

Installation Instructions for the Universal B-Vent Cap

Contents



Universal B-Vent Cover
Part A

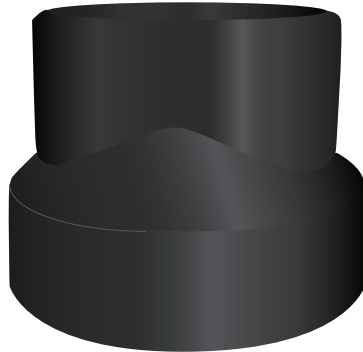

Universal B-Vent Cover
Part B

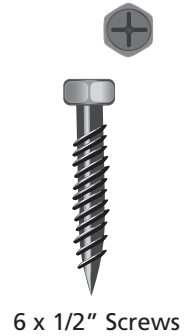

6 x 1/2" Screws

Configuration Options

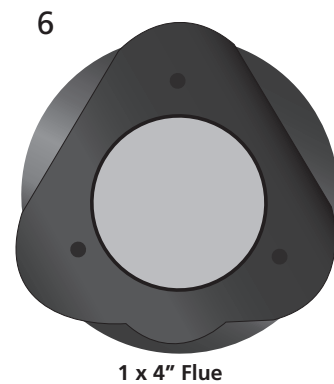
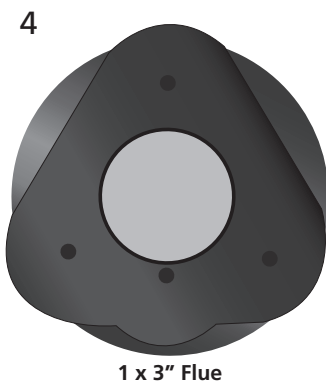
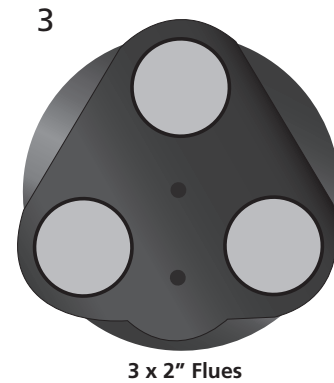
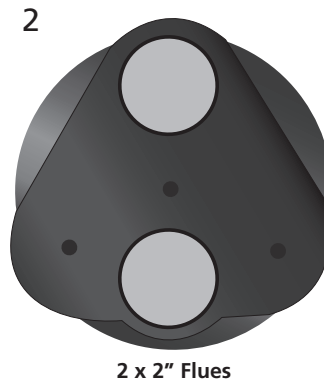
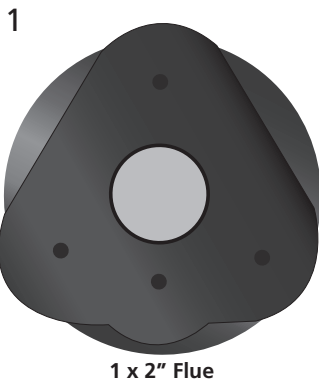

*Hole Saw Sizes for InnoFlue diameters:

2 7/8" for InnoFlue® 2" diameter

3 1/2" for InnoFlue® 3" diameter

4 3/4" for InnoFlue® 4" diameter

*Hole saw not provided by Centrotherm

Installation Instructions for the Universal B-Vent Cap

Installation Instructions

Prepare the Cap

Use locking pliers (or other clamping device) to hold Universal B-Vent Cap Part A and Part B together. Use a hole saw to drill holes to desired configuration. Insert appropriate gasket(s) into holes of Universal B-Vent Cap Part B.

1 Remove existing B-Vent Cap. If retrofitting B-Vent larger than 6" a B-Vent Reducer must be installed after removing previous cap. InnoFlue® Flex should now extend approximately 2' above B-Vent chase. Place Universal B-Vent Cap Part A over Flex pipe and B-Vent until B-Vent Cap step rests level on B-Vent.

2 Anchor the Universal B-Vent Cap Part A to the B-Vent in appropriate recessed step using 3 of the 1/2" screws provided.

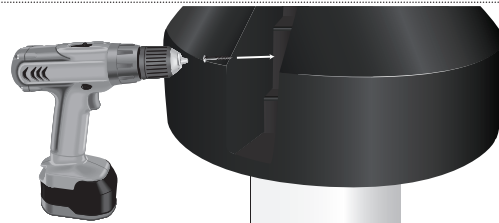

3 Slip Locking Ring(s) over the Flex pipe(s).

4 Cut Flex pipe(s) flush with Flex End Pipe Locking Ring(s).

5 Connect Flex End Pipe(s) into Locking Ring(s).

6 Push Universal B-Vent Cover Part B with gasket(s) over End Pipe(s) until the bottom of the outer is within 1/8" of flush. Fasten at triangle tips using 3 of the 1/2" screws provided. Insert a Bird Screen (sold separately) into Flex End Pipe (if required by local code).

