

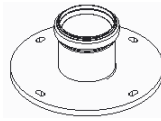

## REPLACEMENT OF FACTORY PROVIDED ADAPTOR WITH ISAFLG (SIZES 3" THROUGH 12")

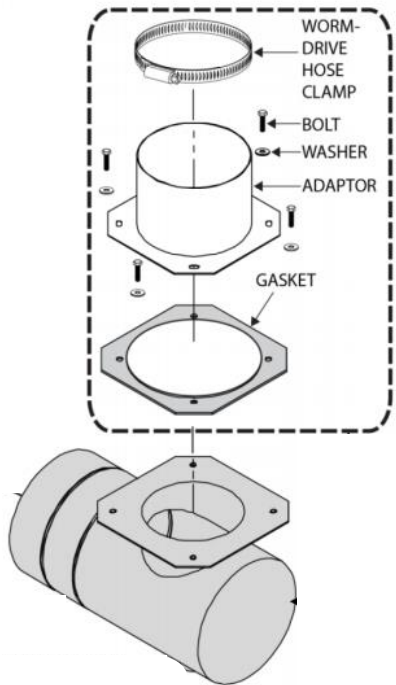

**ISAFLG03**

INCLUDES 4 WASHERS

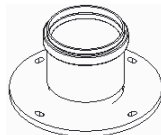

**ISAFLG04**

INCLUDES 4 WASHERS

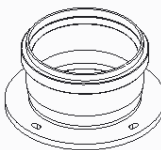

**ISAFLG06**

INCLUDES 4 WASHERS

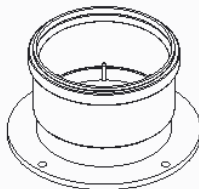

**ISAFLG08**

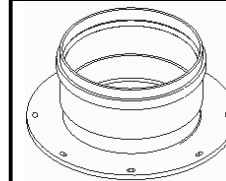
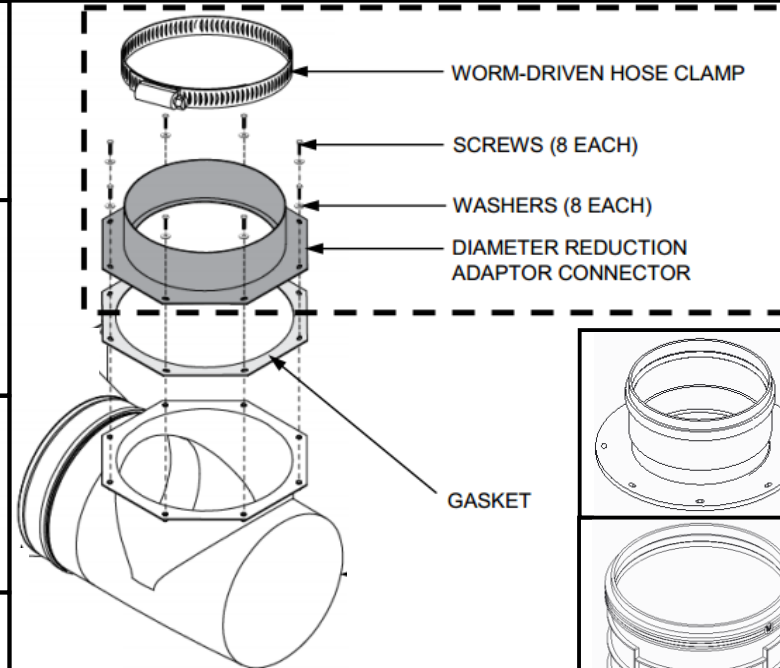

**ISAFLG10**

INCLUDES 8 WASHERS

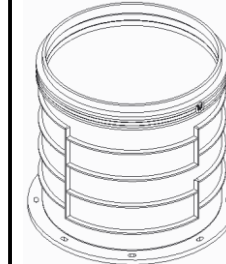

**ISAFLG12**

INCLUDES 8 WASHERS

1. REMOVE FACTORY PROVIDED ADAPTOR AND REPLACE WITH ISAFLG. INSPECT THE GASKET TO CONFIRM THAT IT IS IN PROPER WORKING CONDITION (NO CRACKS, SPLITS, DEFORMATIONS, ETC.) IF THE GASKET IS DAMAGED, DISCARD IT. DO NOT ATTEMPT TO USE IT.
2. IF A GASKET IN PROPER WORKING CONDITION IS NOT AVAILABLE, YOU MUST PLACE A BEAD OF HIGH TEMPERATURE SILICONE SEALANT ON THE BOTTOM FACE OF THE ISAFLG BETWEEN THE BOLT CIRCLE HOLES AND THE FLUE GAS HOLE BEFORE BOLTING DOWN THE ISAFLG.
3. BOLT DOWN THE ADAPTOR, MAKING SURE TO SEAL THE GASKET (OR HIGH TEMPERATURE SILICONE BEAD) IN BETWEEN THE HEAT EXCHANGER AND THE ADAPTOR. USE WASHERS PROVIDED WITH ISAFLG TO PREVENT DAMAGE TO THE PLASTIC FLANGE
4. WORM-DRIVE HOSE CLAMP WILL NOT BE NEEDED